

# American Solar<sup>★</sup>

**WHOLESALE**

## Monocrystalline

ASW-100M

Engineered in the USA & Made Abroad

"QUALITY YOU CAN COUNT ON"

### Features

- TUV, CE, VDE, ISO, IEC CERTIFIED
- High Module Conversion Efficiency
- Fast and Inexpensive Mounting
- Maximizes System Output by Reducing the Mismatch Loss.
- 100% EL Testing on All ASW Modules, Guaranteed No Hotspot
- Guaranteed Positive Output Tolerance (0+3%)
- Withstand High Wind (2400 Pa) and Snow Loads (5400 Pa)
- Excellent Performance in Low Light Environments



### Function

- Off-grid
- RV and Boat
- 12 V Battery Charging

### Precautions

Only qualified personnel should install or perform maintenance. Please read the American Solar Wholesale Installation Manual before installation. Be aware of dangerous high DC voltage; Do not install modules when wet or broken.

### Linear Warranty

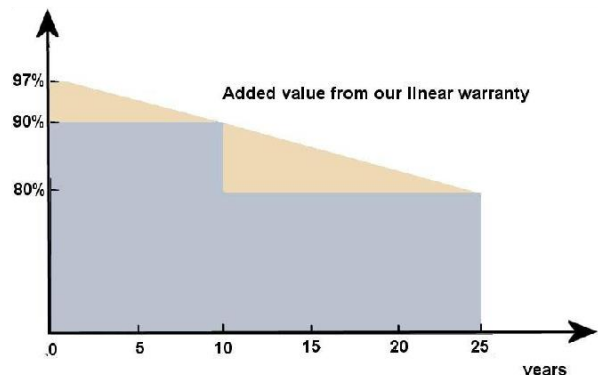

All ASW solar modules are guaranteed to perform for 25 years from the date of purchase. Performance standards insure linear production levels starting at 97.5% at the end of the first year and a maximum decrease of only .07% each year thereafter.

- 5 years at 95% or above
- 5 more years at 90% or above
- 15 more years at 80% or above
- 10 year material & workmanship guarantee

## Electrical

Maximum Power at STC (Pmax)	100 W
Optimum Operating Voltage (Vmp)	17.7 V
Optimum Operating Current (Imp)	5.7 A
Open-Circuit Voltage (Voc)	21.4 V
Short-Circuit Current (Isc)	6.3 A
Maximum System Voltage	600 VDC

STC: Irradiance 1000 W/m<sup>2</sup>, module temperature 25°C, AM=1.5

## Mechanical

Solar Cell	Monocrystalline 6" x 6"
Cells	36 ( 4 x 9 )
Dimensions	26.6 x 39.6 x 1" (inch)
Weight	17.1 lbs
Front Glass	3.2 mm (0.13 inches) tempered glass
Frame	Anodized aluminum alloy
Junction Box	IP65 rated
Output Cables	4.0 mm <sup>2</sup> ( 0.006 inches <sup>2</sup> ), 800mm ( 31.5 inches )
Connectors	MC4 connectors
Fire Rating	Class A (depending on racking assembly)

## Maximum Ratings

Operating Module Temperature -40°C to +90°C

## Diagram

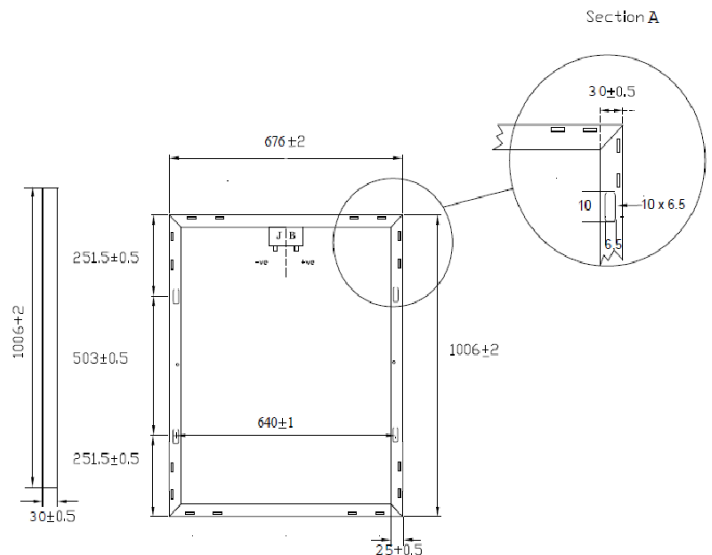

## Temperatures

Nominal Operating Cell Temperature	( NOCT ) 47±2°C
Temperature Coefficient of Pmax	-0.44%/°C
Temperature Coefficient of Voc	-0.30%/°C
Temperature Coefficient of Isc	0.04%/°C

## Wiring Diagram

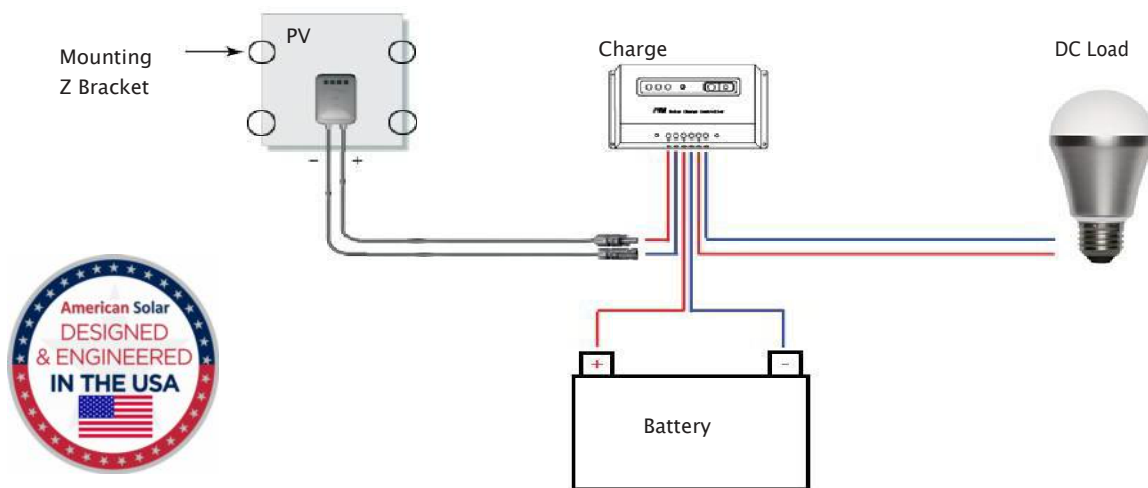

Our modules are certified by 5 testing organizations:

